

TECHNICAL FILE:

13A Switched Socket Outlet



1.- Technical specifications

Rated voltage: 250 V ~

Rated current: 13A

Manufactured according to BS4662 standard

Single and double switched socket outlets with double insulated rockers.

Single outlet with single pole switch.

Double outlet with double pole switch and dual earth.

Flush mounting in standard 1 gang box (75X75 mm) with a recommended minimum depth of 25 mm. Boxes according to BS 4662:2006

Screw terminals (accepts from 2X6 mm² and 3X4 mm² cross section cable)

Shutters included

2.- Material characteristics

Body: Polycarbonate

Glow wire test: 850 °C

Body support: Polyamide GF30

Terminals: Brass CuZn33

Screws: Steel CQ15. Slotted pan head. Metric thread M4

Plate: Stainless steel, aluminium and brass.

Frame: Zamak (optional)

3.- Certificate approvals

ASTA certificate No. 11319

Height dimensions (size in mm)

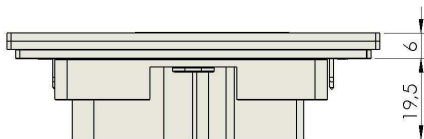

Frame dimensions (size in mm)

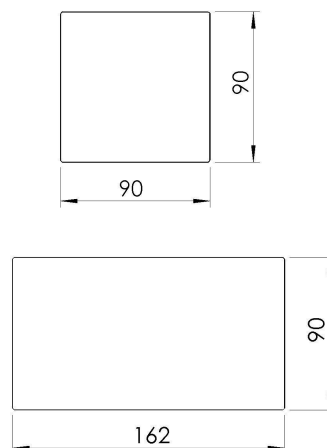

Frame combinations

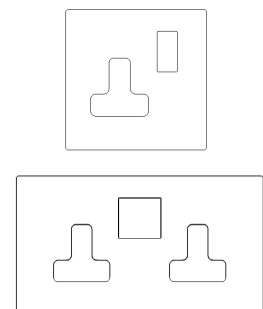

Installation diagram

Flush mounting box installation

In order to keep a distance of 10 mm between frames, it is necessary that flush box must be installed with the distances as shown in next figures. Please check that single and double frame will have different distances between boxes.

