

TECHNICAL FILE:

Multistandard socket



1.- Technical specifications

Plugs accepted:

- EURO CEE7/16. Euro plug (pin 4mm)
- CEE7/4 16 A 250V. Schuko plug (pin 4.8 mm)
- NEMA1 15 A 250V. American plug non-polarized
- NEMA5 15 A 125V. American plug polarized
- BS546 5 A 250V. Indian plug. Old small british standard.
- GB2099 10 A 250V. Chinese plug.
- AS-3122 10 A 250V. Australian plug.
- BS1363 13 A 250V. British plug.

Flush mounting in universal box according EN-60-670 standard

Screw terminals (accepts from 1 mm² to 2.5 mm² cross section cable)

Any plate combination can be produced combining switches, sockets, dimmers,...

Any plate size according to your requirements.

2.- Material characteristics

Body: Polycarbonate

Glow wire test: 850 °C

Terminals: Brass CuZn33

Screws: Steel CQ15. Slotted Phillips pan head. Metric thread M3.5

Plate: AISI 304 Stainless steel, aluminium, brass and Corian®.

Frame: Zamak (optional)



3.- Certificate approvals

Non-certificable product

Height dimensions (size in mm)

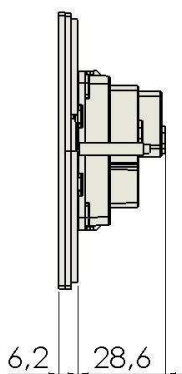

Plate dimensions (size in mm)

